



## 1930 & 2030 FRAMELESS SCREENS - FITTING INSTRUCTIONS

### Angle Front – HA

#### Included in this package:

1 x Bag 1	<input type="checkbox"/>
1 x Bag 11	<input type="checkbox"/>
1 x Set 'E' Handles	<input type="checkbox"/>
2 x 135 ° Hinges	<input type="checkbox"/> <input type="checkbox"/>
1 x Clear Silicon	<input type="checkbox"/>
1 x Blue Masking Tape	<input type="checkbox"/>
1 x Door Fitting Instructions	<input type="checkbox"/>

#### Other equipment required

<input type="checkbox"/>	Flat Screw Driver
<input type="checkbox"/>	Pozi Drive Screw Driver
<input type="checkbox"/>	Adhesive Application Gun
<input type="checkbox"/> <input type="checkbox"/>	Level
<input type="checkbox"/>	Pencil
<input type="checkbox"/>	Drill

*The following instructions show installation when using **Acrylic Liner**.*

*When this system is having **Tiled Walls** the Wall Channels are to be installed directly onto the Waterproofing Membrane.*

*Once Wall Channels have been installed walls are to be tiled. Glass Screens are to be installed as per following instructions.*

*If a protective cover is adhered to base it should be left in place until frameless screen installation is complete.*

TO MAKE SURE THAT YOU HAVE THE MOST UP TO DATE INSTRUCTIONS, SCAN THE FOLLOWING QR CODE. THIS WILL LINK YOU TO THE LATEST INSTRUCTION FILE ON OUR WEBSITE:



## 2 Wall – HA

1. Choose door direction

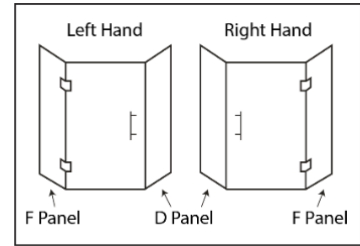

2. Position wall channel over base channel. Mark wall to indicate where wall channel is plumb.

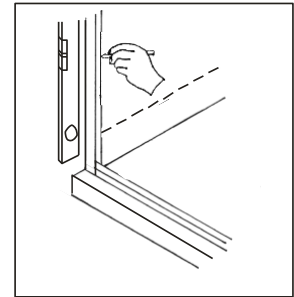

3. Ensure the glass receiver channels are located firmly over the base glazing channels.

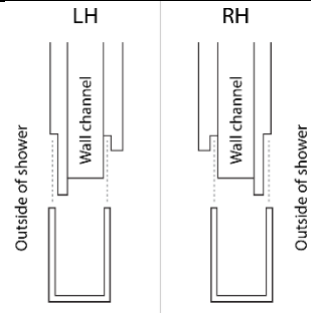

4. Apply a silicon seal to full length of channel. Silicon used must be compatible with anodised aluminium as well as the waterproofing used.

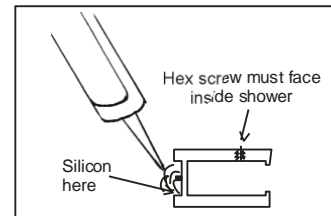

5. Locate framing timber. Use 4mm drill bit to drill holes through wall channels. Fix four screws into each channel (use wall plugs if required).

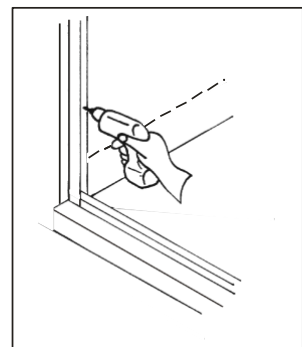

6. Apply a 10mm continuous bead of Flexicone, to the full length of each wall channel. Silicon seal the join where the wall and base channel will intersect. Screw the wall channels to the wall (ensuring they are plumb).

**Acrylic Liner (Fig.1)** - apply an additional bead of silicon to the outside of the acrylic liner.

**Tiled Walls (Fig.2)** – apply an additional bead of silicon to the inside of the waterproofing

Fig.1 -Acrylic Liner  
– Silicon seal outside wall channel

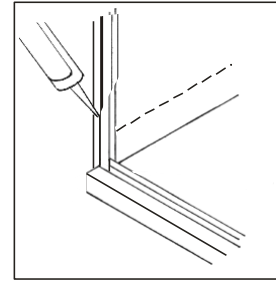
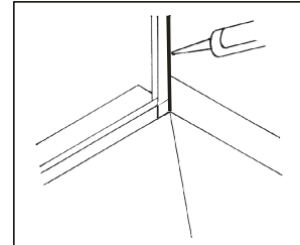
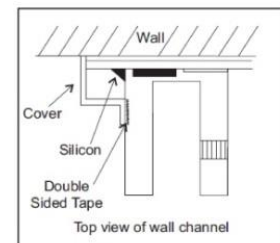

Fig.2 - Tiled Walls  
–Silicon seal inside wall channel



**This step only applies if acrylic wall liner has been supplied.**

7. Fix liner cover to wall channel covering exposed liner edge as shown.



8. Keep glass standing upright. Once package containing glass is opened, check glass is facing same direction up as label, do not sit glass directly on floor, always sit glass on polystyrene packaging or similar padded surface. Keep glass level with floor to avoid hitting corners on hard surfaces.

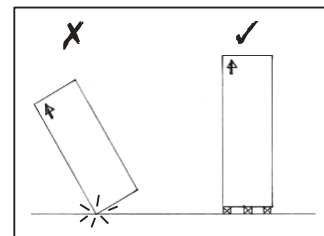

**No responsibility will be taken by Atlantis for any glass breakages through installers actions causing breakage.**

9. The sill infill will be taped into the base glazing channel. The infill must measure 3mm larger than the door, trim if necessary. Slide this sill infill firmly to panel **D** side of bottom channel. Tape in position.



**Protect all channels from adhesive and grouts by covering with masking tape.**

10. Start by placing plastic packers into bottom channels in locations as shown. Add or remove other packers if required.

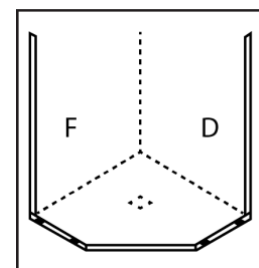

**11. Critical Seal.** Remove any dust and dirt first. Seal the connection between the glass receiver channel and the base glazing channel with clear silicon, prior to final glass placement. Ensure junction between wall channel and base channel is full of silicon before final glass placement.

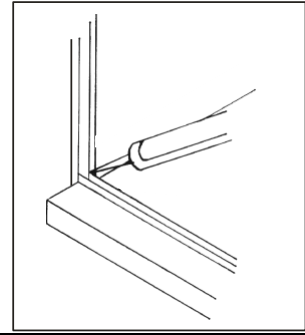

**12.** Apply a generous quantity of silicone at either end of the sill infill prior to final glass placement.

**The following steps for installing glass must be followed to ensure a professional result.**

**13.** Locate panel **D** into channels firmly against sill infill. Adjust height of panel if necessary by adding or removing packers in bottom channel. Ensure panels are flush to top of channel and plumb.

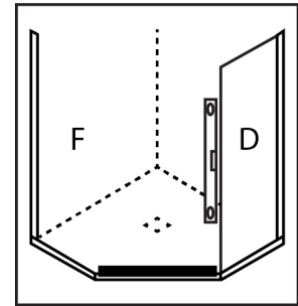

**14.** Locate panel **F** into channels and slide firmly to sill infill. Adjust this panel ensuring it is level and plumb to panel **D** by adding or removing packers in bottom channels.

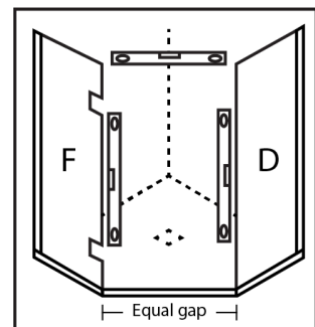

### **15. Fixing of glass panels into wall channels**

Fix glass into channels by tightening hex screws firmly with hex keys supplied. Ensure glass return panels line up with each other when viewed in the directions as shown by arrows.

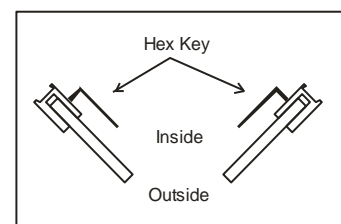

**16.** Assemble handles as shown. Fit handles to glass door prior to installing door in position. Fix ferrule screws through glass. **Do not over tighten.** Locate second handle over ferrules. Tighten two grub screws with small hex key supplied.

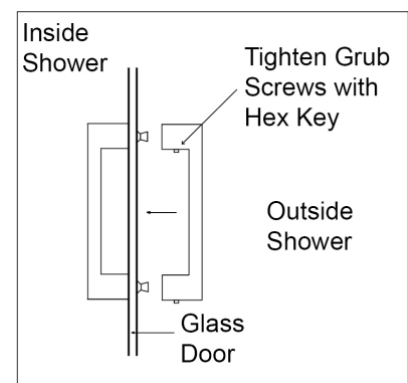

- 17.** Place 6mm packers over sill before installation of glass door to allow correct clearance for door.

Apply 3mm plastic packer to edge of glass with masking tape as shown. Position one next to each hinge cut out (this will ensure correct door clearance and prevent glass damage during installation).

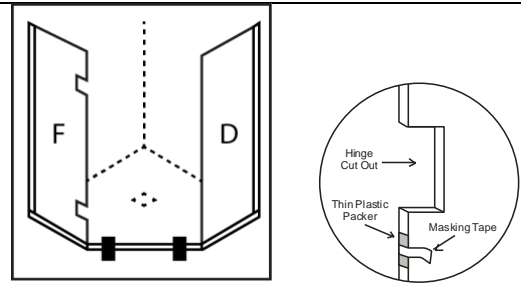

- 18. Hinge Installation.** Atlantis glass (*EXCLUDING 1930MM HIGH GLASS*) is now coated with CristalCote glass protection in the factory. This coating may cause the hinge to slip after installation. Atlantis recommends cleaning around the hinge cut out prior to fitting hinges. Clean both sides of the glass 15mm around the edge of the cut out with Fuelite (fuellite is available from petrol stations).

- 19. Adjustable Hinges – Atlantis showers are now supplied with adjustable hinges**

#### COVER PLATE REMOVAL

Remove the cover plate by loosening the small grub screws on the edge of the hinge cover using a 1.5mm hex key. Loosen the bolts with 4mm hex key.

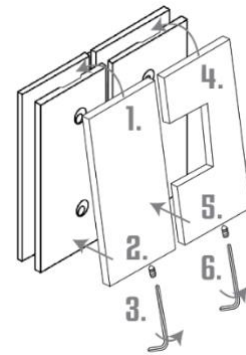

- 20.** Install hinges. Fit correct side of hinge as shown onto panel F. Ensure hinges are centred in glass cut outs. The cover plates should be on the outside of the shower.

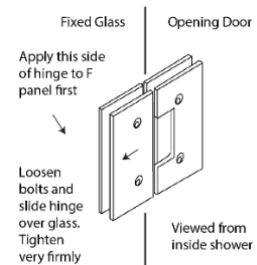

#### 21. Door Installation

**Hinges should be in the closed position (in line) before attempt in to install the glass door.**

Slide the door into the hinges. Centre the door between the side panels and tighten the hinge bolts firmly with the 4mm hex key supplied.

**ENSURE HINGES ARE CLEAR FROM SIDES OF GLASS CUTOUTS AND HINGE BOLTS ARE FINALLY TIGHTENED AS MUCH AS POSSIBLE.**

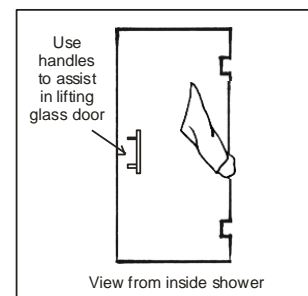

## 22. DOOR REALIGNMENT

If required, use 3mm hex key to loosen the cap screws highlighted, align the door to desired position and then re-tighten.

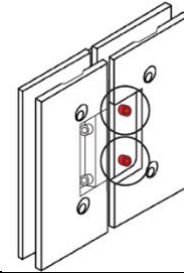

## 23. REFIT COVER PLATE

Place the cover plate over the hinge body as shown. Refit cover plate with a 1.5mm hex key

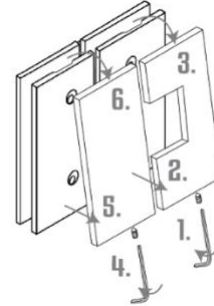

## 24. Door clearances

Minimum clearance of 3mm under door.

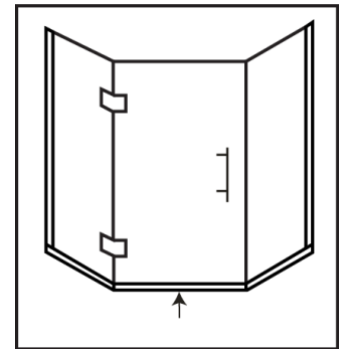

25. This is the general layout of the complete door. See Step 24 & 25 for notes on Door Seal Installation.

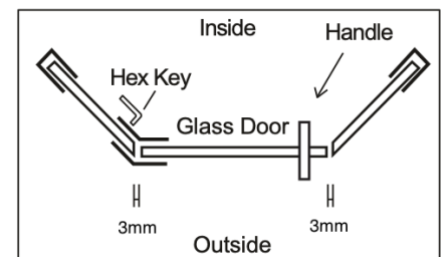

26. Drill and screw the blocks on to the top brace, as per the positioning guide supplied. Place the brace onto the screens and tighten the top brace block grub screws to secure the brace. Do not over tighten grub screws onto the glass.



27. Mask channels and glass in position as shown. Apply clear silicon to inside and outside of glass panels. Use spatula to remove excess.

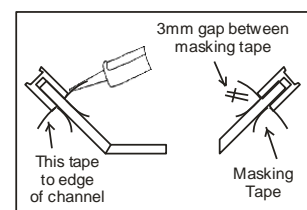

**28. Door Opening Sill Infill** – Apply a continuous bead of clear silicon to each inside face of the base channel. Ensure the ends of the infill are sealed and place into the base channel as shown.

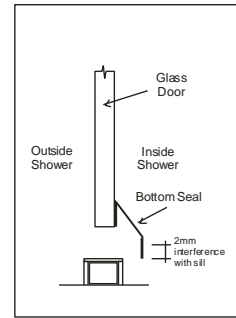
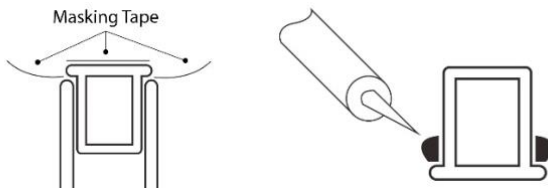

Install bottom door seal. Trim to length if necessary. Clip onto the bottom of the door. Ensure the sloping face is inside the shower.

**29. Door Seal Installation** – install seals as shown. Trim the **Y SEAL** to length to fit between the hinges.

