



# Installation Instructions – Tile-Over EasyNiche

## EASY NICHE – EN-BAG20

### Included in this package:

- |         |  |                          |
|---------|--|--------------------------|
| 1 x     | Connection Strip<br>B2000(80mmx2000mm) | <input type="checkbox"/> |
| 1 x     | Bottle of Primer                       | <input type="checkbox"/> |
| 12<br>x | 8# 32 CSK S/S SCREWS                   | <input type="checkbox"/> |
| 1x      | Instructions                           | <input type="checkbox"/> |

Checked By \_\_\_\_\_

Date \_\_\_\_\_

**INSTALLER:** Please consult with tile-layer on placement of EasyNiche to match finished tile grout lines.

Step 1: Measure and create extra framing (1) to support the Easy Niche in the desired position.

Step 2: Ensure that the screw holes line up with supporting nogs/studs (see Fig.1)

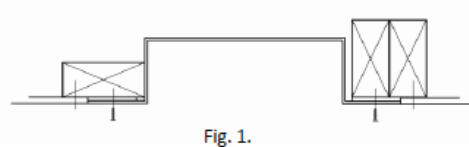

Step 3: Before screwing the EasyNiche into its final position, ensure that the wallboard will finish flush with the outside edge of the EasyNiche flange. Pack-out the EasyNiche if required. Screw fix the EasyNiche into place (Fig.2)

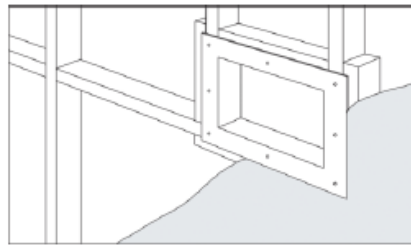

Step 4: Apply Primer onto wallboard around outside perimeter of EasyNiche (to approx. 75mm and then apply primer to EasyNiche Surface (Fig.3)

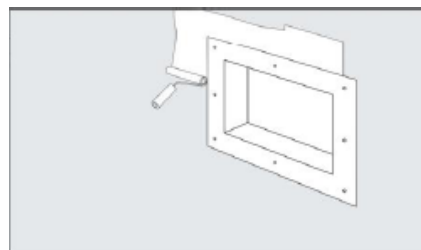

Step 5: Ensure EasyNiche surfaces are clean and free of dust. (Clean with acetone or methylated spirits only.)

**IMPORTANT: CONNECTION BAND MUST BE IN PLACE BEFORE ANY WATERPROOFING OR TILES ARE APPLIED.**

AS THE EASYNICHE IS ALREADY 100% WATERPROOF, THE FUNCTION OF THE MEMBRANE BAND IS TO PROVIDE A WATERPROOF CONNECTION TO THE WALL AND AID ADHESION OF TILES AND SUPPLEMENTARY WATERPROOFING.

Step 6: Using a sharp knife, cut along the trimmed line of the Connection Sheet (A), to fully remove the centre portion.

Step 7: Starting by folding down 30mm of the backing release paper at the top edge, apply the Connection Sheet (A) over the entire Niche face and onto the primed wall board area. Press firmly to ensure total adhesion (fig.4)

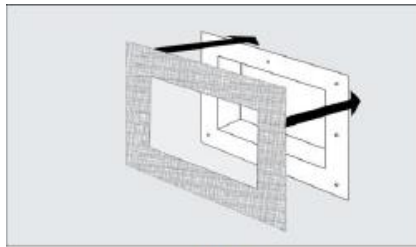

Fig. 4

Step 8: With the sharp knife, trim the excess patch around the inside of the Niche recess (Fig.5)

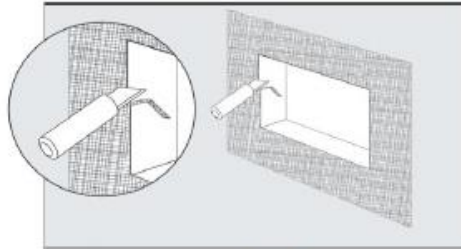

Fig. 5

Step 9: Apply the centre portion of the Connection Sheet (A) to the back face of the Niche. Press firmly to ensure total adhesion (Fig.6)

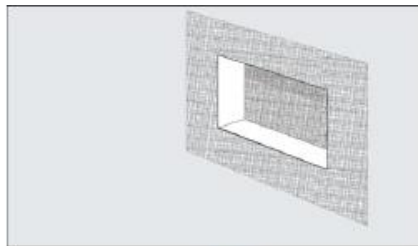

Fig. 6

Step10: Apply the 80mm Connection strip (B) to inside edges of Niche (4 sides). Press firmly to ensure total adhesion (Fig.7)

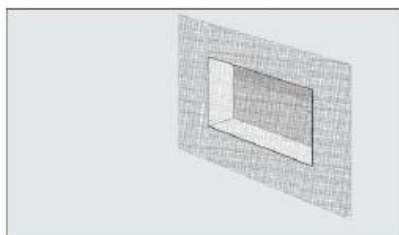

Fig. 7

**The Shower walls are now ready to be waterproofed and once this is done the EasyNiche is ready to be tiled.**

**Most Cement & Acrylic based liquid waterproofing products are compatible with this membrane– see overleaf.**



## **Recommended Compatible Liquid Waterproofing** - for use with Atlantis Essential Connections

Once the Atlantis Reinforcement Bands/Essential Connections have been applied to the wall and Atlantis Shower Base, the following liquid waterproofing products can be used with this system:

CHEVALINE DEXX (Equus)  
DAMPFIX 3, DAMPFIX PU, DAMPFIX GOLD Wet Area Membrane (ASA Bostik)  
DAVCO K10 PLUS Wet Area Membrane (Davco)  
DUROSET and DUROQUIK Wet Area Membrane (Waterproofing Systems)  
FLEXI-SEAL Interior Waterproofing Systems (Flexco)  
GRIPSET 38 Liquid Rubber Membrane (Gripset Industries)  
LATICRETE Hydro Ban Waterproofing Membrane (Global Tile)  
LIQUID FLASH 2 Waterproofing Membrane (Construction Chemicals)  
MAPEGUM WPS and MAPELASTIC Wet Area Membranes (Mapei)  
RASOLASTIK and RASOGUM Wet Area Membranes (Protective Surfaces)  
SUPERFLEX Wet Area Membrane (Ardex)  
ULTRASEAL Wet Area Membrane (ASA Bostik)  
WPM001 / WPM300 Waterproofing Membranes (Ardex)

### **WARRANTY**

Atlantis Bathroom Style Pty Ltd warrants that the adhesion of these products to the Reinforcement Bands, subject to correct application by a properly qualified tradesperson.